

DOORHAN[®]

SANDWICH PANELS FOR SECTIONAL DOORS

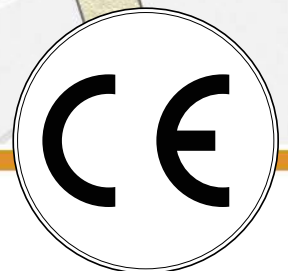
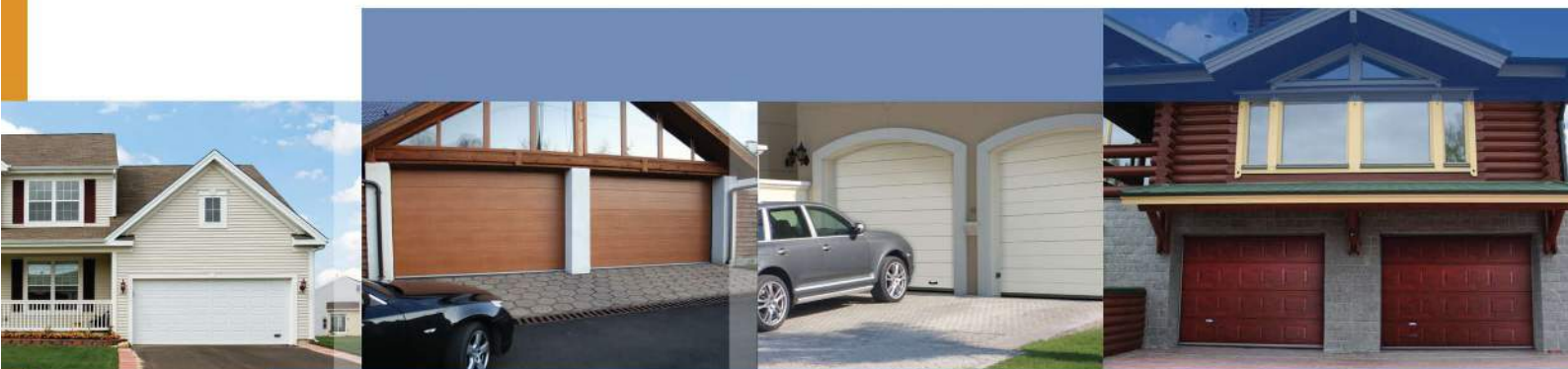

STRUCTURE AND DIMENSIONS OF SANDWICH PANELS

STRUCTURE OF SANDWICH PANELS

FINGER PROTECTION PANEL

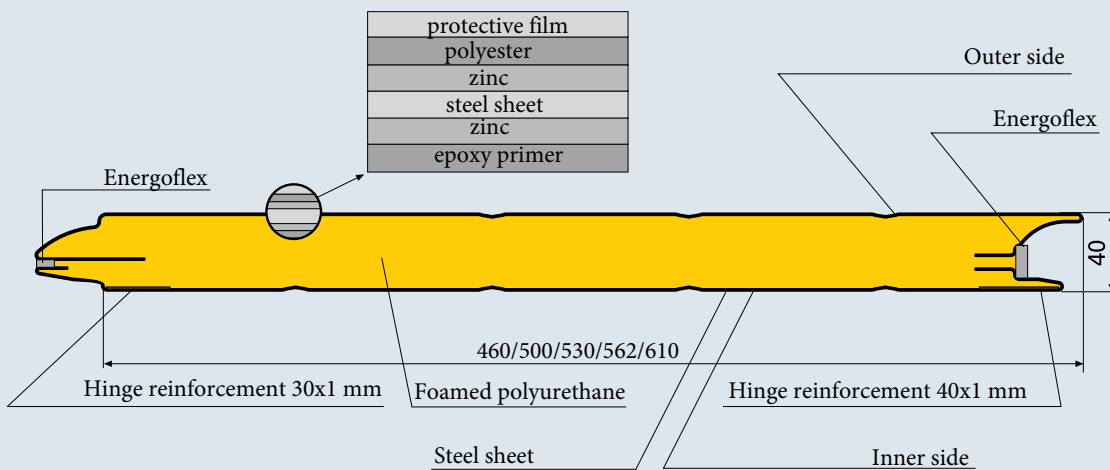

INDUSTRIAL PANEL WITHOUT FINGER PROTECTION

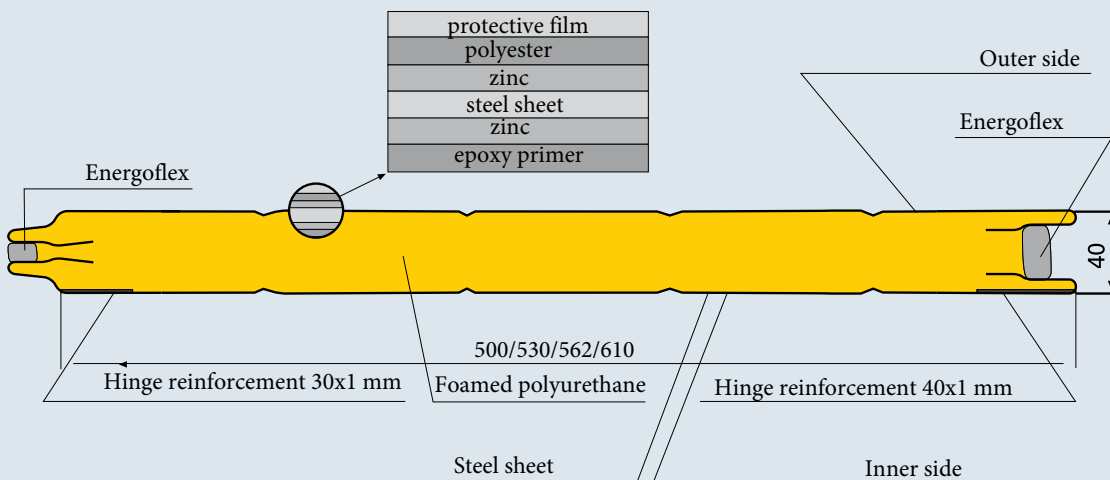

DIMENSION OF SANDWICH PANELS

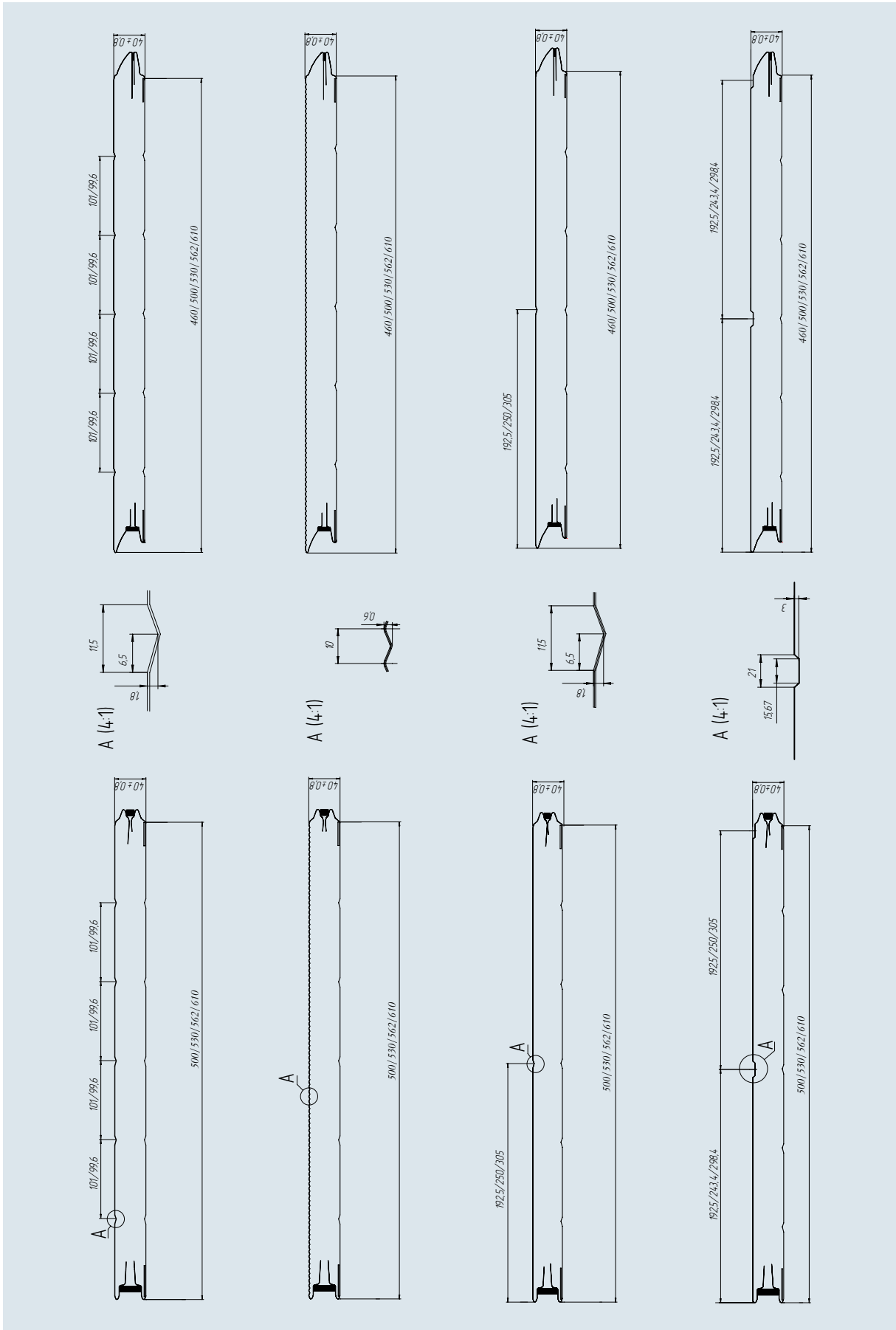

DIMENSIONS AND DESIGN OF SANDWICH PANELS

CASESTTE PANEL

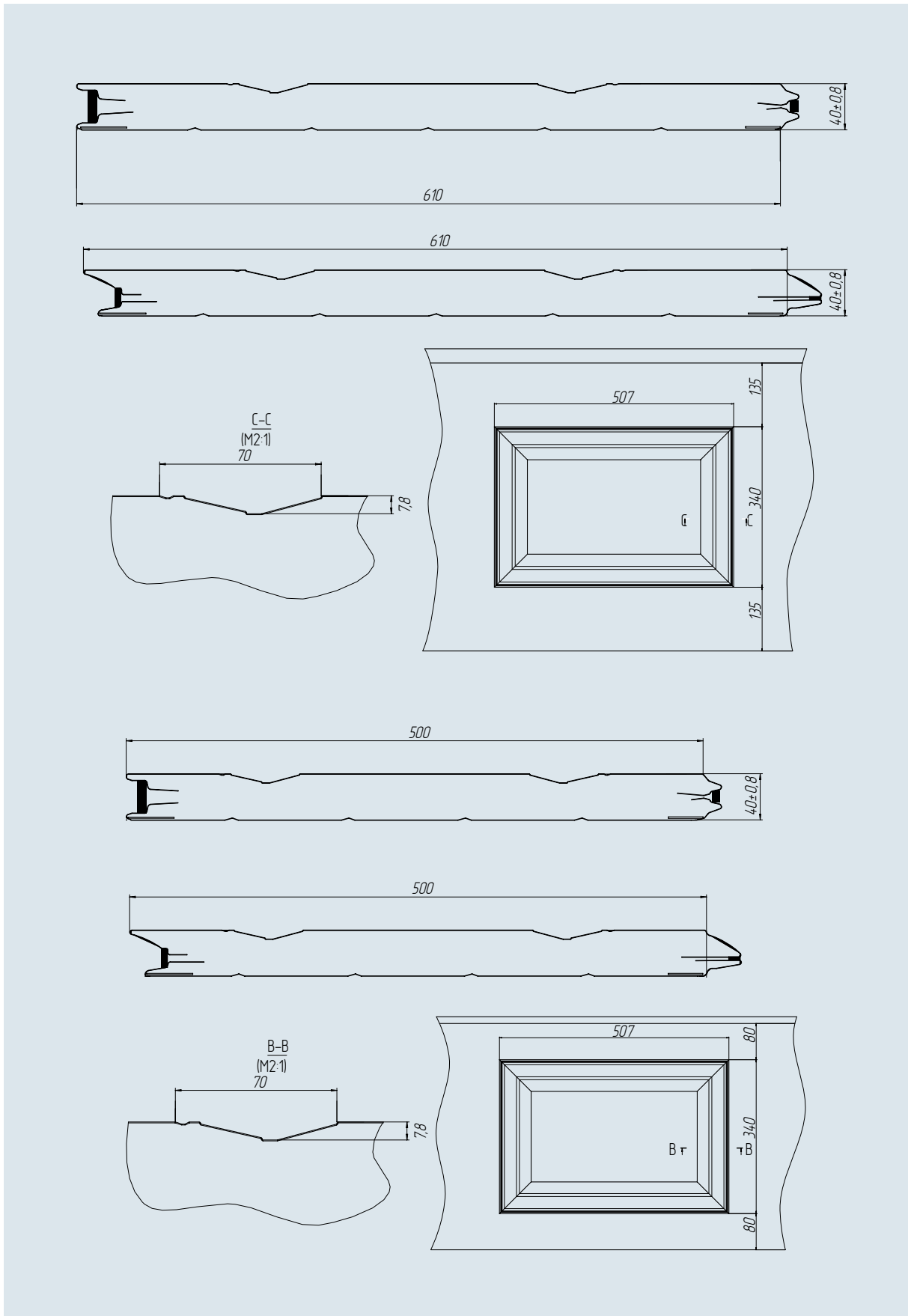

DESIGNE OF THE OUTSIDE OF THE PANEL

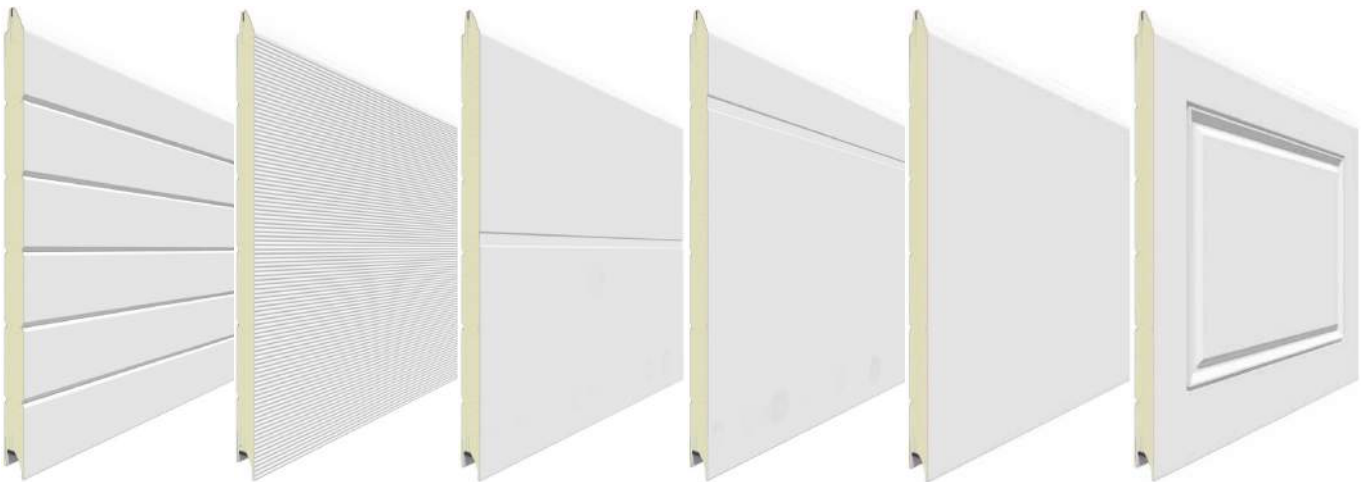

S-line V-line M-line T-line W-line Cassette

The inside of the panel is standardly produced in S-line design.

SURFACE STRUCTURES



SMOOTH

STUCCO

WOODGRAIN

PVC LAMINATION



DARK OAK

GOLDEN OAK

MAHOGANY

WENGE

SATIN GREY

* PANEL TYPE M-LINE

STANDARD RAL COLOURS

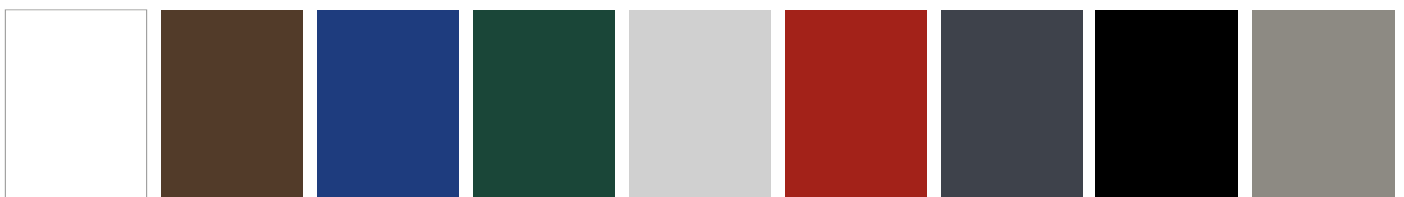

RAL 9010

RAL 8014

RAL 5005

RAL 6005

RAL 9006

RAL 3000

RAL 7016

RAL 9005

RAL 9007



Panels can be painted in any colour from the International RAL Colour Chart. Colour swatches printed on this page may not accurately display the original colours. Please use the original RAL Colour Chart.

THERMAL PROPERTIES AND PACKING OF SANDWICH PANELS

THERMAL PROPERTIES

NO COLD BRIDGE EFFECT

- the front and back sheets are not connected, which ensures heat insulation and prevents freezing.

FOAMED POLYURETHANE

- the seal made of high-quality material increases the durability of the sandwich panels and reduces heat loss.

ENERGOFLEX

- advanced technology of heat insulation, non-absorbing and wear-resistant material.

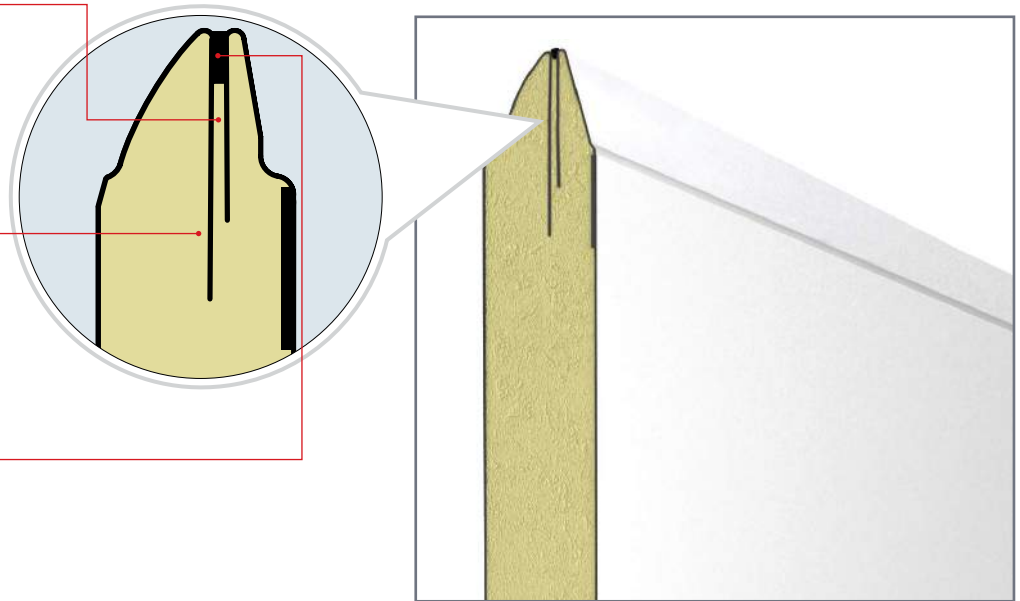

Sandwich panel is made from two sheets of galvanized steel, filled with high quality thermal insulator - foamed polyurethane, which reduces the heat loss and prolongs service life of the door. The front and back steel sheets are not connected, eliminating cold bridge effect, which ensures heat insulation and prevents from freezing. In joint is polyurethane isolated by durable and waterproof EnergoFlex.

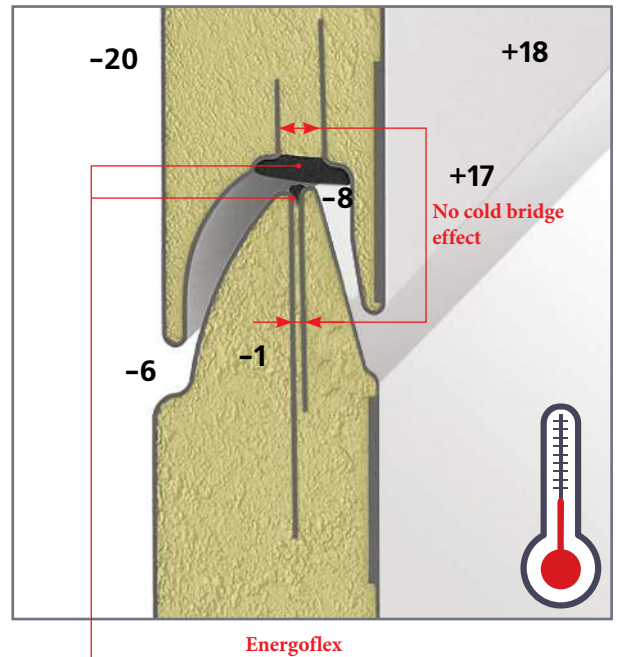

PACKAGE



For safe transportation are sandwich panels packed by 18 pieces in stacks long up to 13500 mm. The corners and the sides of the stack are covered in polystyrene and the whole package is wrapped in foil.

Every stack has its individual marking.

PLANT AND SUBSIDIARIES



CZECH REPUBLIC,
KADAN

DOOR SYSTEMS DOCKING SYSTEMS AUTOMATION SYSTEMS

**CZECH REPUBLIC,
KADAN**
432 01, Královský Vrch 2018
Tel.: +420 474 319 111
E-mail:
kadan@doorhan.com
www.doorhan.com
www.doorhan.cz

**POLAND,
POZNAN**
ul. Gdyńska 131,
62-004 Czerwonak
Tel.: +48 612 245 031
E-mail:
pozn@doorhan.com
www.pl.doorhan.com

**POLAND,
WARSZAWA**
ul. Kolejowa 231a,
05-092 Dziekanów Polski
Tel.: +48 885 261 134
E-mail:
warszawa@doorhan.com
www.pl.doorhan.com

**FINLAND,
KERAVA**
Peltomäenkatu, 04250
Tel.: 050 550 0330
E-mail:
myynti@doorhan.com
www.doorhan.fi

